

Lot Area: 950 m²
 Building Envelope Area: 588 m²

Front Yard Setback: 2.0 m
 Rear Yard Setback: 6.0 m
 Interior Side Yard Setback: 1.5 m
 Exterior Side Yard Setback: 4.5 m



Strata Lot 1, Plan EPS9008 - Crystal Lake

This Lot Plan is provided for information purposes only. This Lot Plan has been prepared based on the most recent information available at the time and is believed to be true and accurate, however, no warranty as to accuracy is provided by the Developer. The Lot owner shall confirm all dimensions, elevations, and other information provided herein prior to use of this plan. This Lot Plan shall not be construed as a legal survey. The Developer and its employees, contractors, consultants and agents shall not be liable for any losses arising from use of this plan. E&OE.



KOOCANUSA VILLAGE

10 May 2023

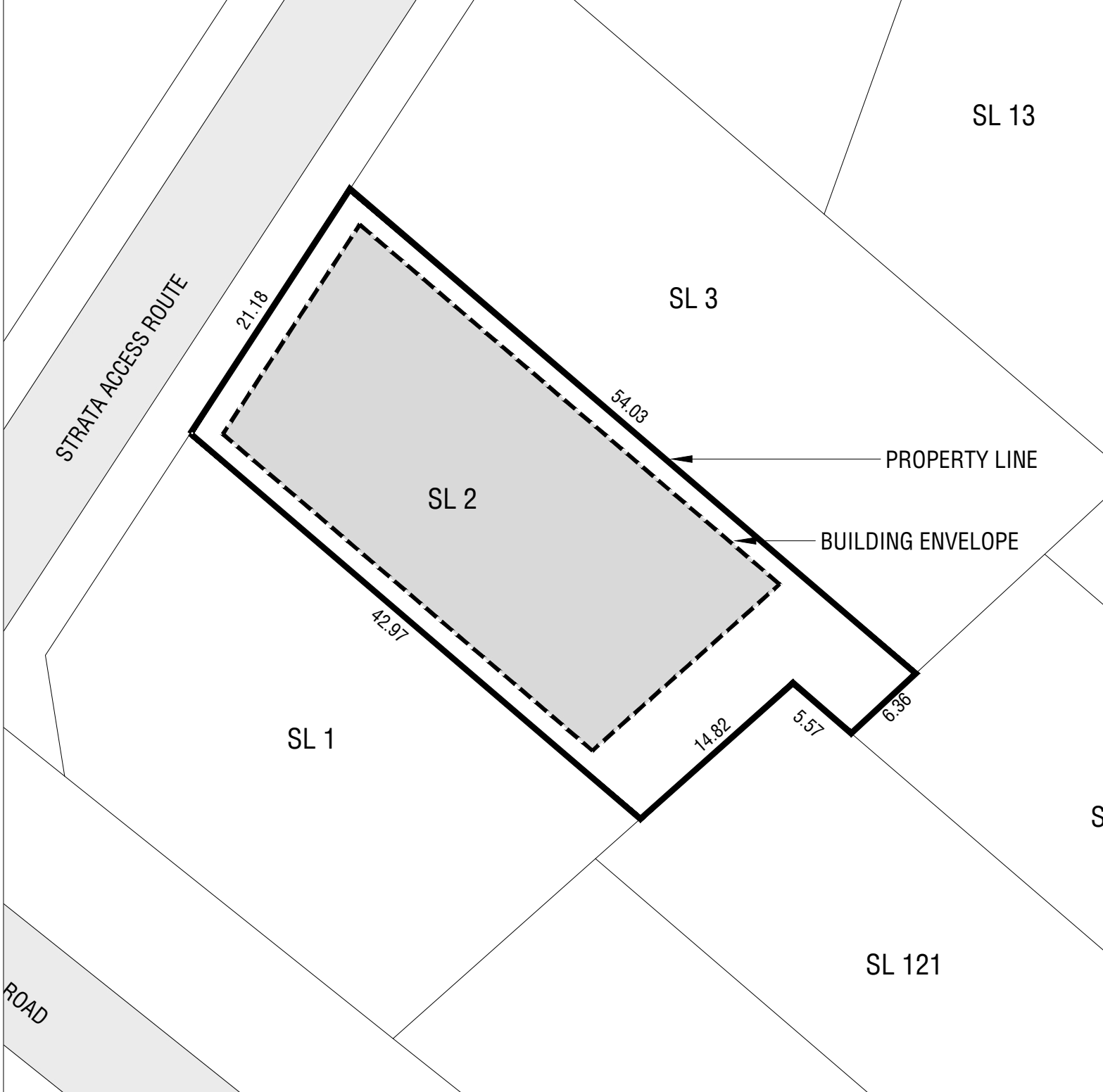

Lot Area: 996 m²
 Building Envelope Area: 678 m²
 Front Yard Setback: 2.0 m
 Rear Yard Setback: 6.0 m
 Interior Side Yard Setback: 1.5 m



Strata Lot 2, Plan EPS9008 - Crystal Lake

This Lot Plan is provided for information purposes only. This Lot Plan has been prepared based on the most recent information available at the time and is believed to be true and accurate, however, no warranty as to accuracy is provided by the Developer. The Lot owner shall confirm all dimensions, elevations, and other information provided herein prior to use of this plan. This Lot Plan shall not be construed as a legal survey. The Developer and its employees, contractors, consultants and agents shall not be liable for any losses arising from use of this plan. E&OE.



KOOCANUSA VILLAGE

10 May 2023



Lot Area: 1189 m²
 Building Envelope Area: 873 m²
 Front Yard Setback: 2.0 m
 Rear Yard Setback: 6.0 m
 Interior Side Yard Setback: 1.5 m



Strata Lot 3, Plan EPS9008 - Crystal Lake

This Lot Plan is provided for information purposes only. This Lot Plan has been prepared based on the most recent information available at the time and is believed to be true and accurate, however, no warranty as to accuracy is provided by the Developer. The Lot owner shall confirm all dimensions, elevations, and other information provided herein prior to use of this plan. This Lot Plan shall not be construed as a legal survey. The Developer and its employees, contractors, consultants and agents shall not be liable for any losses arising from use of this plan. E&OE.

10 May 2023



Lot Area: 837 m²
 Building Envelope Area: 466 m²

Front Yard Setback: 2.0 m
 Rear Yard Setback: 6.0 m
 Interior Side Yard Setback: 1.5 m
 Exterior Side Yard Setback: 4.5 m



Strata Lot 4, Plan EPS9008 - Crystal Lake

This Lot Plan is provided for information purposes only. This Lot Plan has been prepared based on the most recent information available at the time and is believed to be true and accurate, however, no warranty as to accuracy is provided by the Developer. The Lot owner shall confirm all dimensions, elevations, and other information provided herein prior to use of this plan. This Lot Plan shall not be construed as a legal survey. The Developer and its employees, contractors, consultants and agents shall not be liable for any losses arising from use of this plan. E&OE.



KOOCANUSA VILLAGE

10 May 2023



Lot Area: 727 m²
 Building Envelope Area: 410 m²
 Front Yard Setback: 2.0 m
 Rear Yard Setback: 6.0 m
 Interior Side Yard Setback: 1.5 m
 Exterior Side Yard Setback: 4.5 m



Strata Lot 5, Plan EPS9008 - Crystal Lake

This Lot Plan is provided for information purposes only. This Lot Plan has been prepared based on the most recent information available at the time and is believed to be true and accurate, however, no warranty as to accuracy is provided by the Developer. The Lot owner shall confirm all dimensions, elevations, and other information provided herein prior to use of this plan. This Lot Plan shall not be construed as a legal survey. The Developer and its employees, contractors, consultants and agents shall not be liable for any losses arising from use of this plan. E&OE.

10 May 2023

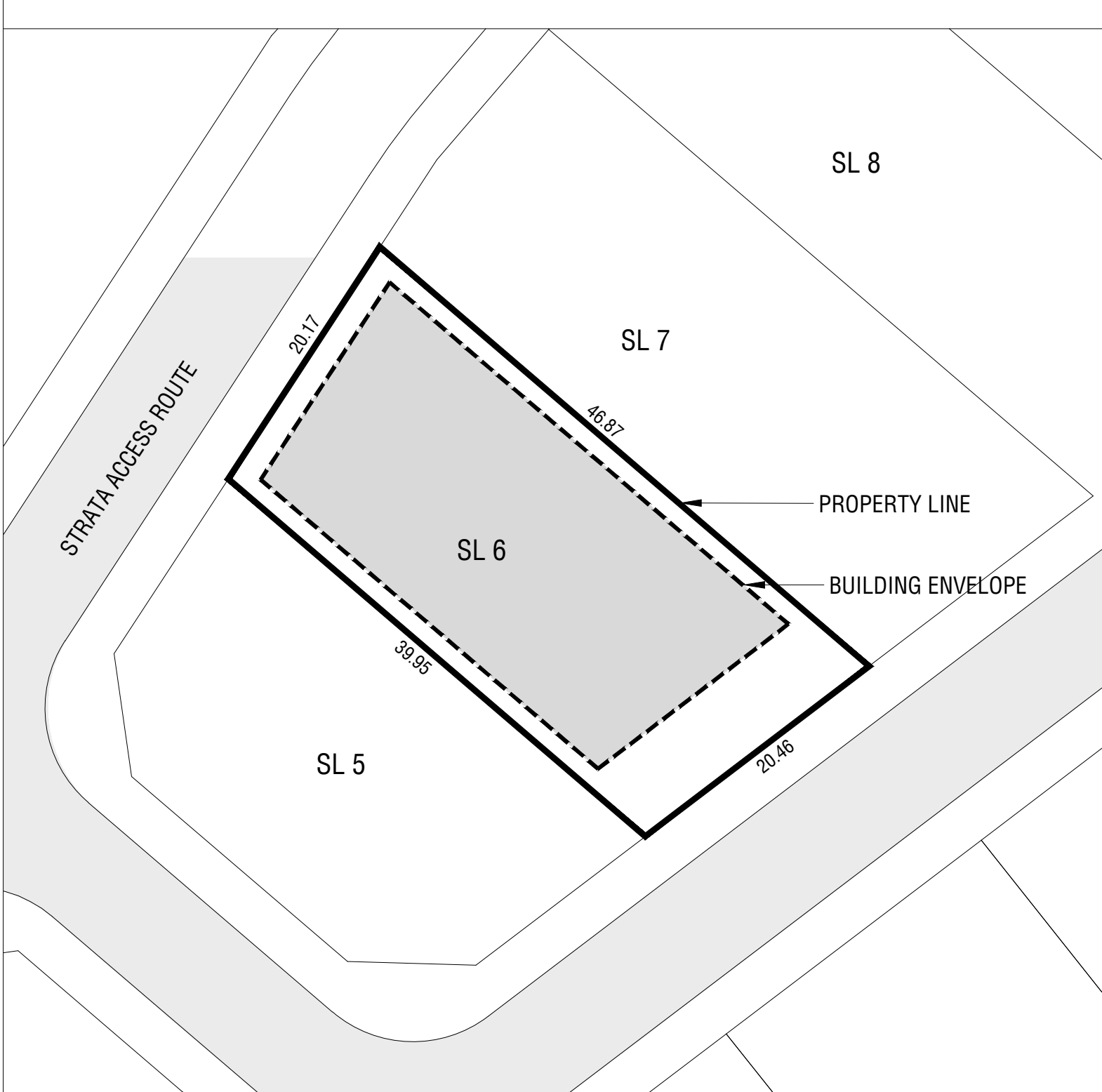

Lot Area: 868 m²
 Building Envelope Area: 599 m²

Front Yard Setback: 2.0 m
 Rear Yard Setback: 6.0 m
 Interior Side Yard Setback: 1.5 m



Strata Lot 6, Plan EPS9008 - Crystal Lake

This Lot Plan is provided for information purposes only. This Lot Plan has been prepared based on the most recent information available at the time and is believed to be true and accurate, however, no warranty as to accuracy is provided by the Developer. The Lot owner shall confirm all dimensions, elevations, and other information provided herein prior to use of this plan. This Lot Plan shall not be construed as a legal survey. The Developer and its employees, contractors, consultants and agents shall not be liable for any losses arising from use of this plan. E&OE.



KOOCANUSA VILLAGE

10 May 2023

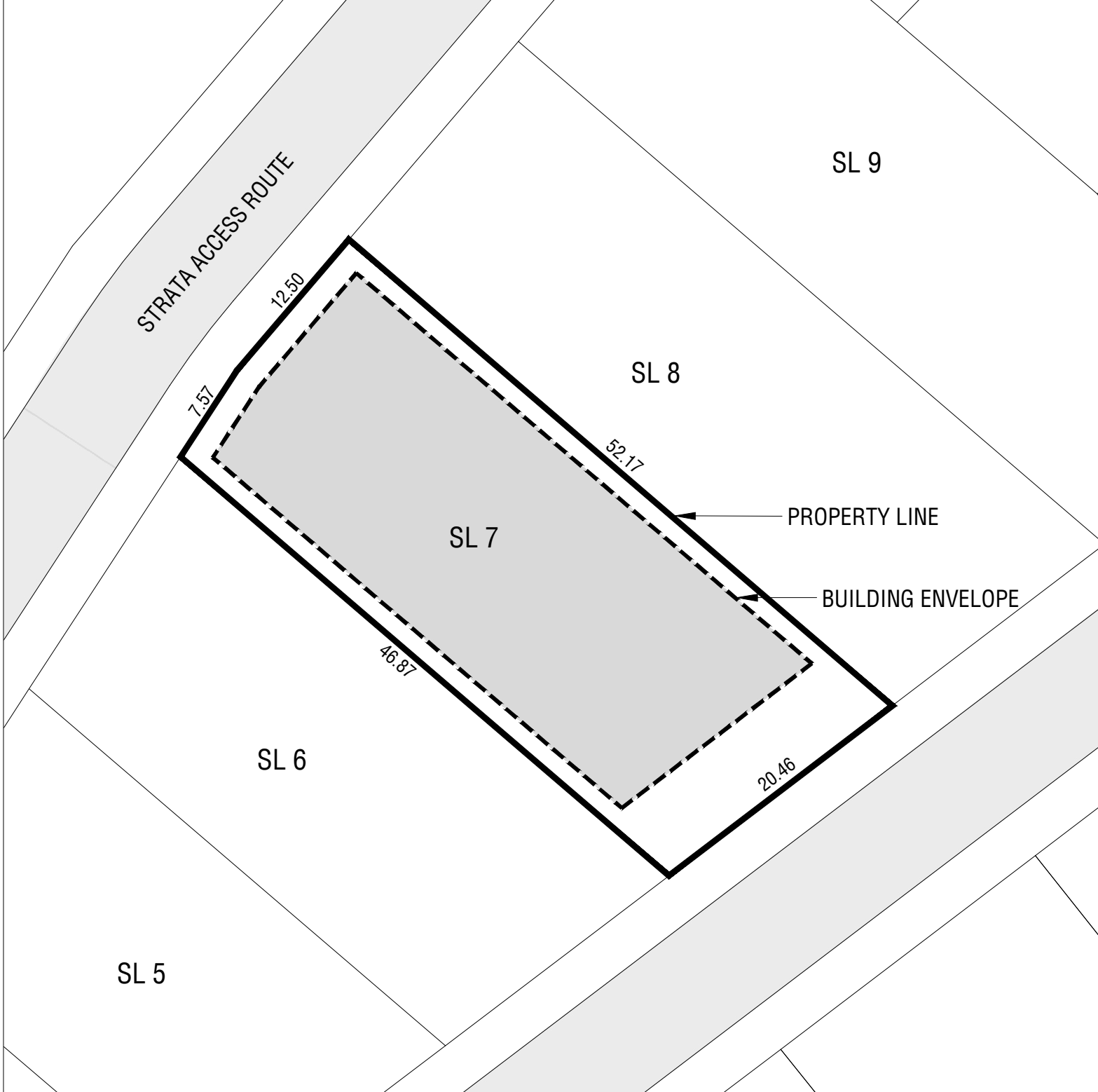

Lot Area: 996 m²
 Building Envelope Area: 709 m²
 Front Yard Setback: 2.0 m
 Rear Yard Setback: 6.0 m
 Interior Side Yard Setback: 1.5 m



Strata Lot 7, Plan EPS9008 - Crystal Lake

This Lot Plan is provided for information purposes only. This Lot Plan has been prepared based on the most recent information available at the time and is believed to be true and accurate, however, no warranty as to accuracy is provided by the Developer. The Lot owner shall confirm all dimensions, elevations, and other information provided herein prior to use of this plan. This Lot Plan shall not be construed as a legal survey. The Developer and its employees, contractors, consultants and agents shall not be liable for any losses arising from use of this plan. E&OE.



KOOCANUSA VILLAGE

10 May 2023

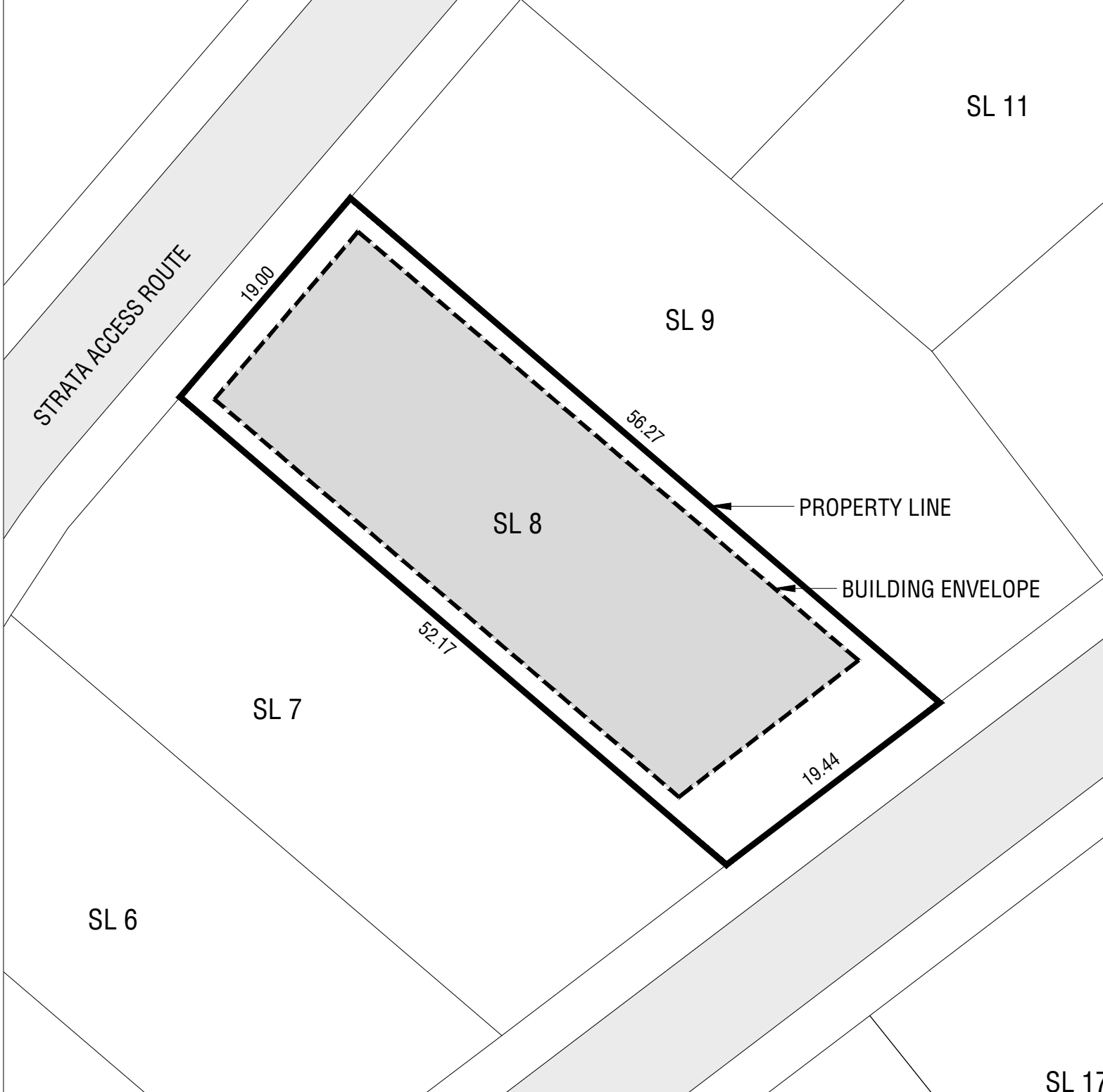

Lot Area: 1030 m²
 Building Envelope Area: 737 m²

Front Yard Setback: 2.0 m
 Rear Yard Setback: 6.0 m
 Interior Side Yard Setback: 1.5 m



Strata Lot 8, Plan EPS9008 - Crystal Lake

This Lot Plan is provided for information purposes only. This Lot Plan has been prepared based on the most recent information available at the time and is believed to be true and accurate, however, no warranty as to accuracy is provided by the Developer. The Lot owner shall confirm all dimensions, elevations, and other information provided herein prior to use of this plan. This Lot Plan shall not be construed as a legal survey. The Developer and its employees, contractors, consultants and agents shall not be liable for any losses arising from use of this plan. E&OE.

10 May 2023



Lot Area: 1062 m²
 Building Envelope Area: 780 m²

Front Yard Setback: 2.0 m
 Rear Yard Setback: 6.0 m
 Interior Side Yard Setback: 1.5 m



Strata Lot 9, Plan EPS9008 - Crystal Lake

This Lot Plan is provided for information purposes only. This Lot Plan has been prepared based on the most recent information available at the time and is believed to be true and accurate, however, no warranty as to accuracy is provided by the Developer. The Lot owner shall confirm all dimensions, elevations, and other information provided herein prior to use of this plan. This Lot Plan shall not be construed as a legal survey. The Developer and its employees, contractors, consultants and agents shall not be liable for any losses arising from use of this plan. E&OE.



KOOCANUSA VILLAGE

10 May 2023



Lot Area: 674 m²
 Building Envelope Area: 420 m²

Front Yard Setback: 2.0 m
 Rear Yard Setback: 6.0 m
 Interior Side Yard Setback: 1.5 m
 Exterior Side Yard Setback: 4.5 m



Strata Lot 10, Plan EPS9008 - Crystal Lake

This Lot Plan is provided for information purposes only. This Lot Plan has been prepared based on the most recent information available at the time and is believed to be true and accurate, however, no warranty as to accuracy is provided by the Developer. The Lot owner shall confirm all dimensions, elevations, and other information provided herein prior to use of this plan. This Lot Plan shall not be construed as a legal survey. The Developer and its employees, contractors, consultants and agents shall not be liable for any losses arising from use of this plan. E&OE.

10 May 2023

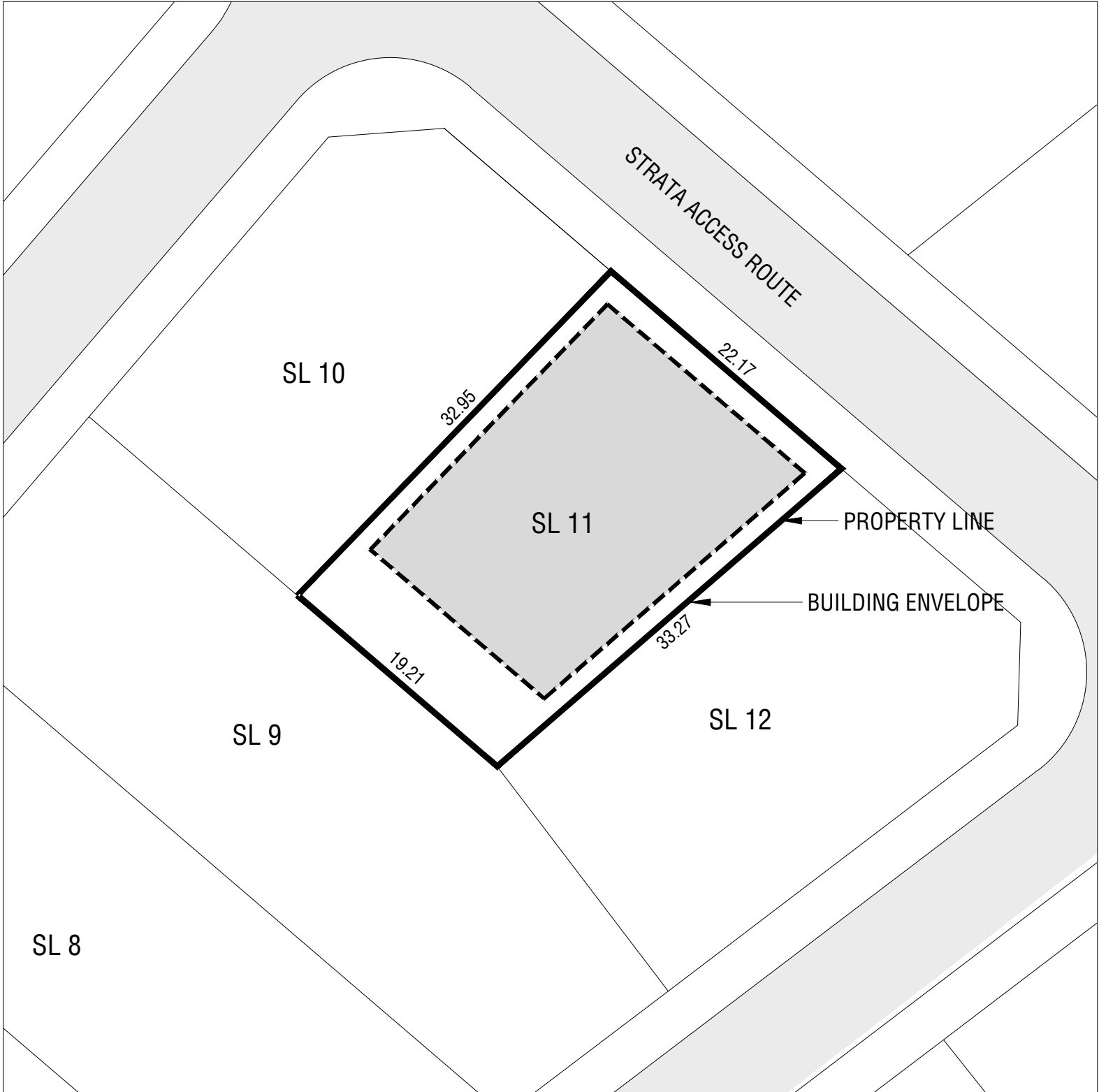

Lot Area: 680 m²
 Building Envelope Area: 444 m²

Front Yard Setback: 2.0 m
 Rear Yard Setback: 6.0 m
 Interior Side Yard Setback: 1.5 m



Strata Lot 11, Plan EPS9008 - Crystal Lake

This Lot Plan is provided for information purposes only. This Lot Plan has been prepared based on the most recent information available at the time and is believed to be true and accurate, however, no warranty as to accuracy is provided by the Developer. The Lot owner shall confirm all dimensions, elevations, and other information provided herein prior to use of this plan. This Lot Plan shall not be construed as a legal survey. The Developer and its employees, contractors, consultants and agents shall not be liable for any losses arising from use of this plan. E&OE.



KOOCANUSA VILLAGE

10 May 2023



Lot Area: 758 m²
 Building Envelope Area: 420 m²

Front Yard Setback: 2.0 m
 Rear Yard Setback: 6.0 m
 Interior Side Yard Setback: 1.5 m



Strata Lot 12, Plan EPS9008 - Crystal Lake

This Lot Plan is provided for information purposes only. This Lot Plan has been prepared based on the most recent information available at the time and is believed to be true and accurate, however, no warranty as to accuracy is provided by the Developer. The Lot owner shall confirm all dimensions, elevations, and other information provided herein prior to use of this plan. This Lot Plan shall not be construed as a legal survey. The Developer and its employees, contractors, consultants and agents shall not be liable for any losses arising from use of this plan. E&OE.



KOOCANUSA VILLAGE

10 May 2023

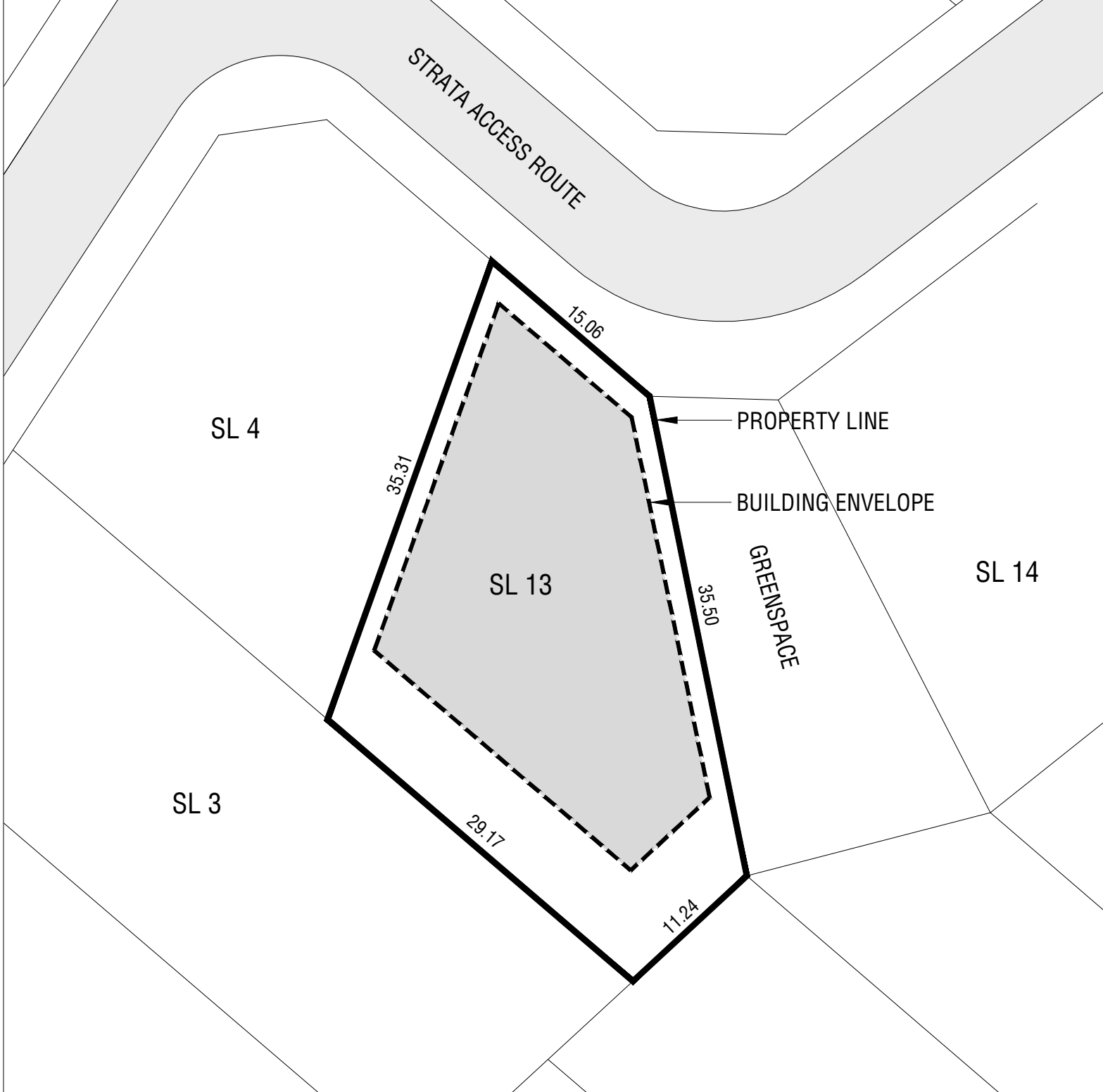

Lot Area: 900 m²
 Building Envelope Area: 558 m²

Front Yard Setback: 2.0 m
 Rear Yard Setback: 6.0 m
 Interior Side Yard Setback: 1.5 m



Strata Lot 13, Plan EPS9008 - Crystal Lake

This Lot Plan is provided for information purposes only. This Lot Plan has been prepared based on the most recent information available at the time and is believed to be true and accurate, however, no warranty as to accuracy is provided by the Developer. The Lot owner shall confirm all dimensions, elevations, and other information provided herein prior to use of this plan. This Lot Plan shall not be construed as a legal survey. The Developer and its employees, contractors, consultants and agents shall not be liable for any losses arising from use of this plan. E&OE.



KOOCANUSA VILLAGE

10 May 2023

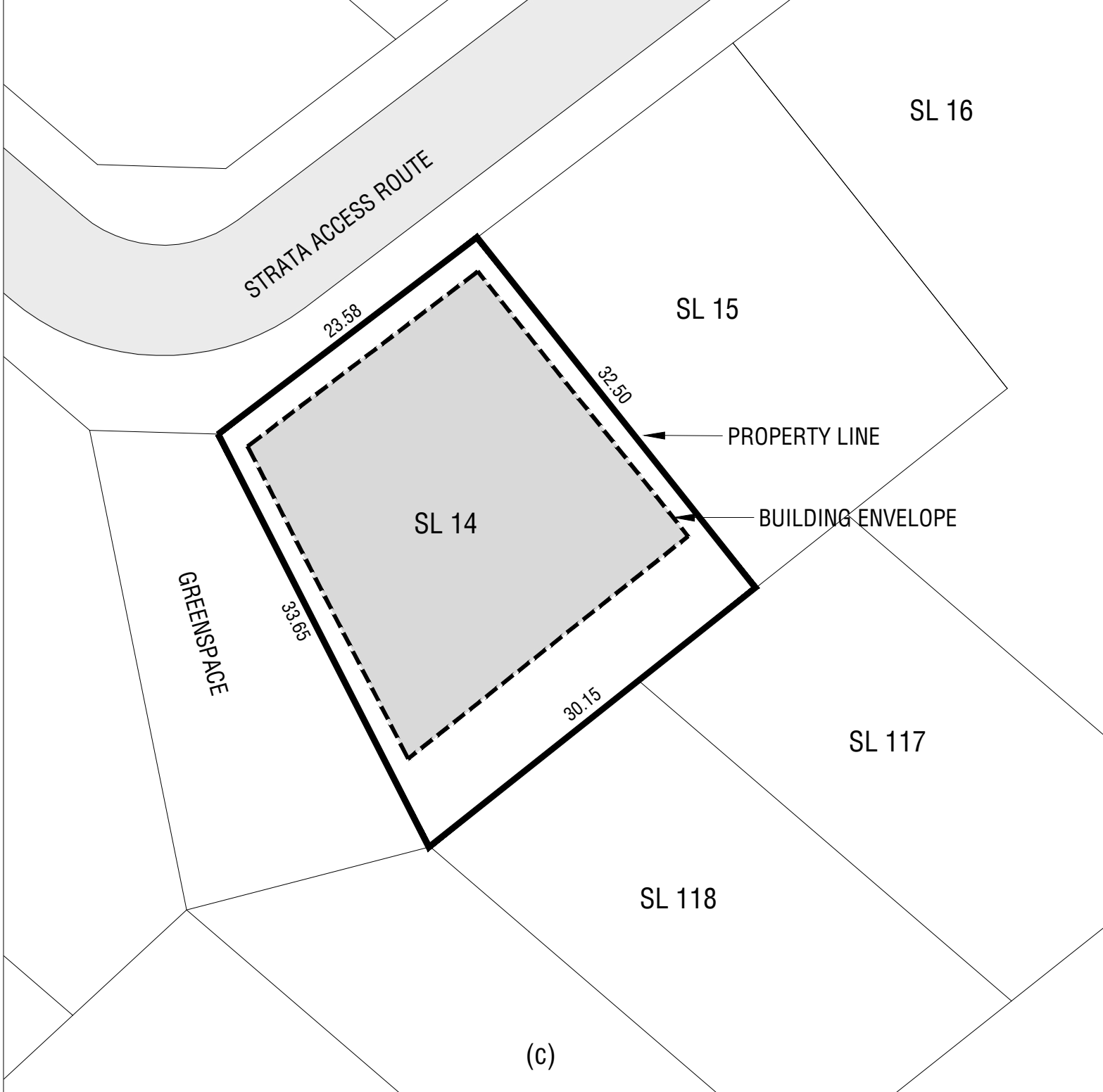

Lot Area: 880 m²
 Building Envelope Area: 580 m²
 Front Yard Setback: 2.0 m
 Rear Yard Setback: 6.0 m
 Interior Side Yard Setback: 1.5 m

(c)



Strata Lot 14, Plan EPS9008 - Crystal Lake

This Lot Plan is provided for information purposes only. This Lot Plan has been prepared based on the most recent information available at the time and is believed to be true and accurate, however, no warranty as to accuracy is provided by the Developer. The Lot owner shall confirm all dimensions, elevations, and other information provided herein prior to use of this plan. This Lot Plan shall not be construed as a legal survey. The Developer and its employees, contractors, consultants and agents shall not be liable for any losses arising from use of this plan. E&OE.

10 May 2023

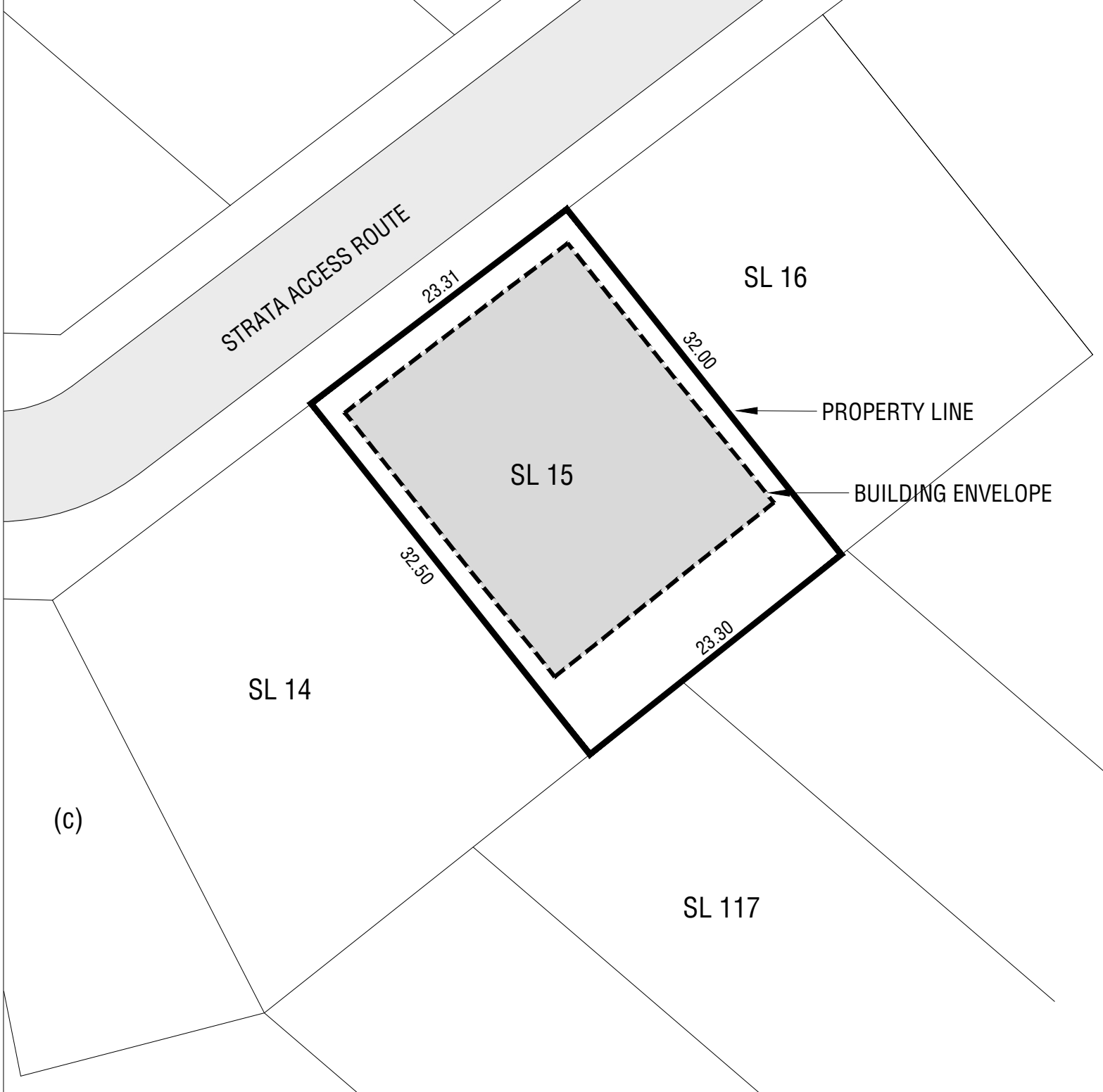

(c)

Lot Area: 751 m²
 Building Envelope Area: 492 m²

Front Yard Setback: 2.0 m
 Rear Yard Setback: 6.0 m
 Interior Side Yard Setback: 1.5 m



Strata Lot 15, Plan EPS9008 - Crystal Lake

This Lot Plan is provided for information purposes only. This Lot Plan has been prepared based on the most recent information available at the time and is believed to be true and accurate, however, no warranty as to accuracy is provided by the Developer. The Lot owner shall confirm all dimensions, elevations, and other information provided herein prior to use of this plan. This Lot Plan shall not be construed as a legal survey. The Developer and its employees, contractors, consultants and agents shall not be liable for any losses arising from use of this plan. E&OE.



KOOCANUSA VILLAGE

10 May 2023

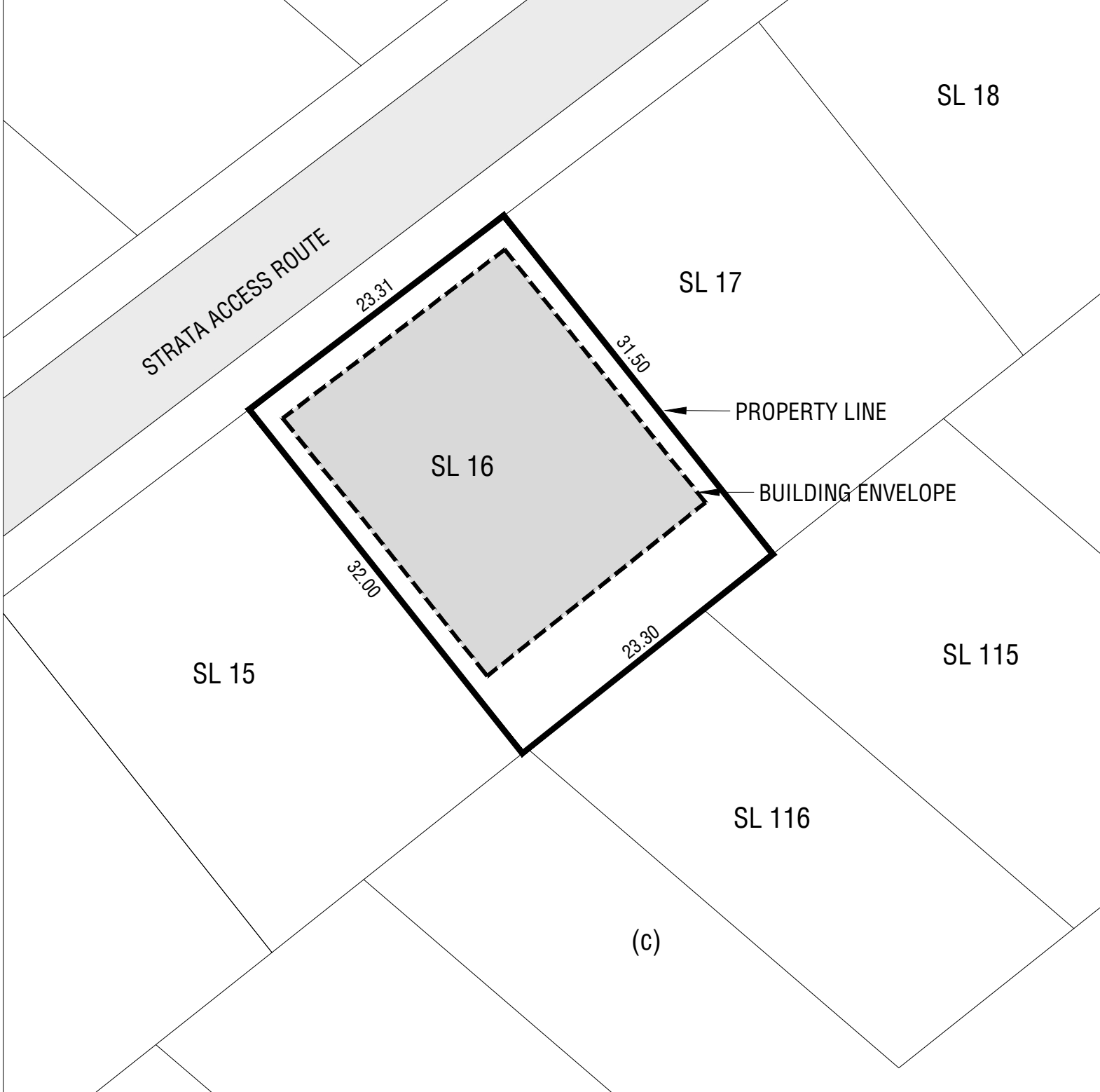

Lot Area: 739 m²
 Building Envelope Area: 481 m²
 Front Yard Setback: 2.0 m
 Rear Yard Setback: 6.0 m
 Interior Side Yard Setback: 1.5 m



Strata Lot 16, Plan EPS9008 - Crystal Lake

This Lot Plan is provided for information purposes only. This Lot Plan has been prepared based on the most recent information available at the time and is believed to be true and accurate, however, no warranty as to accuracy is provided by the Developer. The Lot owner shall confirm all dimensions, elevations, and other information provided herein prior to use of this plan. This Lot Plan shall not be construed as a legal survey. The Developer and its employees, contractors, consultants and agents shall not be liable for any losses arising from use of this plan. E&OE.

10 May 2023



Lot Area: 728 m²

Building Envelope Area: 471 m²

Front Yard Setback: 2.0 m

Rear Yard Setback: 6.0 m

Interior Side Yard Setback: 1.5 m



Strata Lot 17, Plan EPS9008 - Crystal Lake

This Lot Plan is provided for information purposes only. This Lot Plan has been prepared based on the most recent information available at the time and is believed to be true and accurate, however, no warranty as to accuracy is provided by the Developer. The Lot owner shall confirm all dimensions, elevations, and other information provided herein prior to use of this plan. This Lot Plan shall not be construed as a legal survey. The Developer and its employees, contractors, consultants and agents shall not be liable for any losses arising from use of this plan. E&OE.

10 May 2023

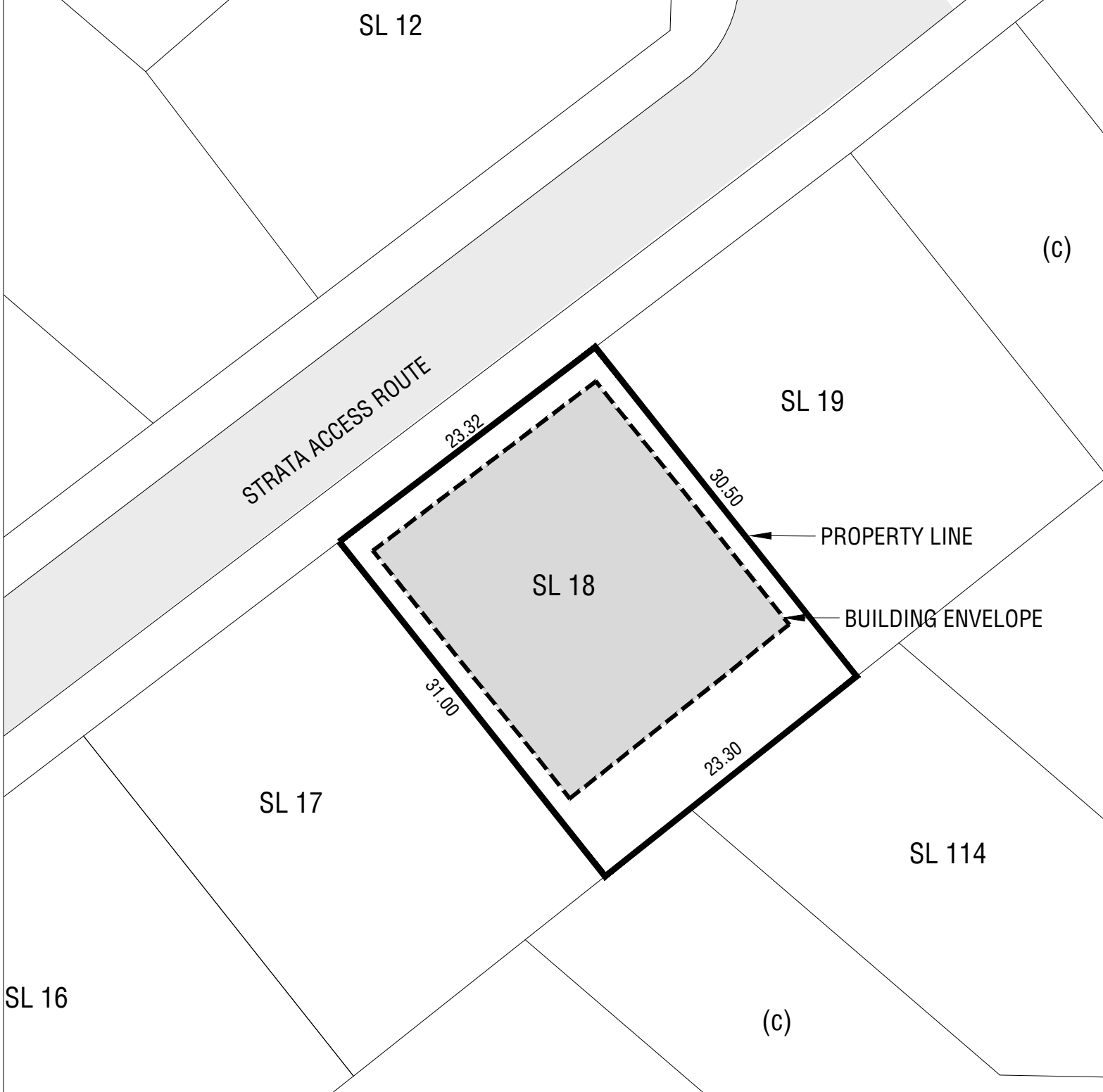

Lot Area: 716 m²
 Building Envelope Area: 461 m²

Front Yard Setback: 2.0 m
 Rear Yard Setback: 6.0 m
 Interior Side Yard Setback: 1.5 m



Strata Lot 18, Plan EPS9008 - Crystal Lake

This Lot Plan is provided for information purposes only. This Lot Plan has been prepared based on the most recent information available at the time and is believed to be true and accurate, however, no warranty as to accuracy is provided by the Developer. The Lot owner shall confirm all dimensions, elevations, and other information provided herein prior to use of this plan. This Lot Plan shall not be construed as a legal survey. The Developer and its employees, contractors, consultants and agents shall not be liable for any losses arising from use of this plan. E&OE.



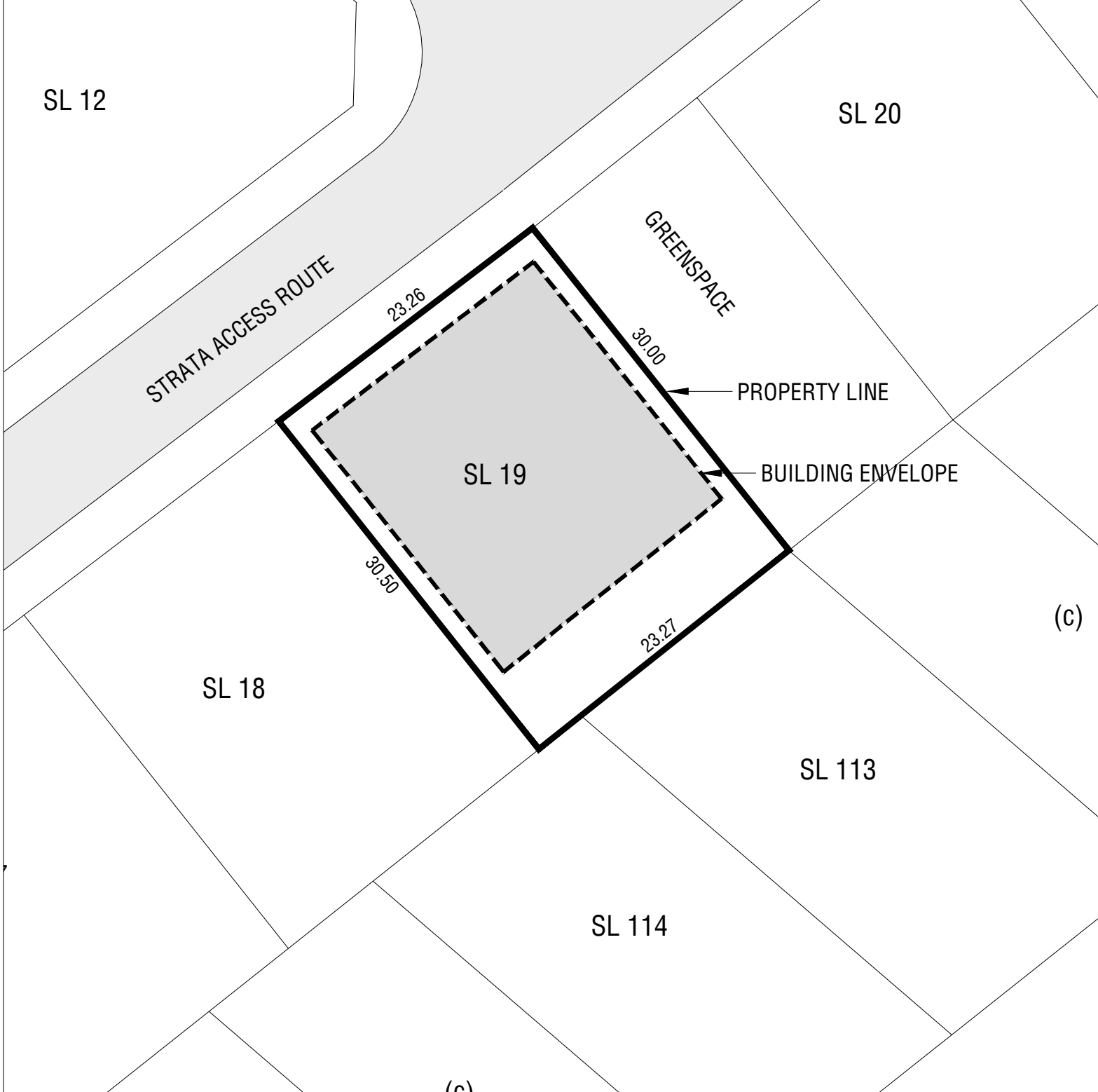

Lot Area: 703 m²
 Building Envelope Area: 450 m²
 Front Yard Setback: 2.0 m
 Rear Yard Setback: 6.0 m
 Interior Side Yard Setback: 1.5 m



Strata Lot 19, Plan EPS9008 - Crystal Lake

This Lot Plan is provided for information purposes only. This Lot Plan has been prepared based on the most recent information available at the time and is believed to be true and accurate, however, no warranty as to accuracy is provided by the Developer. The Lot owner shall confirm all dimensions, elevations, and other information provided herein prior to use of this plan. This Lot Plan shall not be construed as a legal survey. The Developer and its employees, contractors, consultants and agents shall not be liable for any losses arising from use of this plan. E&OE.



KOOCANUSA VILLAGE

10 May 2023

SL 41

SL 22

STRATA ACCESS ROUTE

SL 21

22.87

30.00

PROPERTY LINE

SL 20

BUILDING ENVELOPE

GREENSPACE

30.00

22.87

SL 111

SL 19

SL 112

(c)

Lot Area: 686 m²

Building Envelope Area: 437 m²

Front Yard Setback: 2.0 m

Rear Yard Setback: 6.0 m

Interior Side Yard Setback: 1.5 m



KOOCANUSA VILLAGE

Strata Lot 20, Plan EPS9008 - Crystal Lake

This Lot Plan is provided for information purposes only. This Lot Plan has been prepared based on the most recent information available at the time and is believed to be true and accurate, however, no warranty as to accuracy is provided by the Developer. The Lot owner shall confirm all dimensions, elevations, and other information provided herein prior to use of this plan. This Lot Plan shall not be construed as a legal survey. The Developer and its employees, contractors, consultants and agents shall not be liable for any losses arising from use of this plan. E&OE.

10 May 2023



Lot Area: 662 m²
 Building Envelope Area: 420 m²

Front Yard Setback: 2.0 m
 Rear Yard Setback: 6.0 m
 Interior Side Yard Setback: 1.5 m



Strata Lot 21, Plan EPS9008 - Crystal Lake

This Lot Plan is provided for information purposes only. This Lot Plan has been prepared based on the most recent information available at the time and is believed to be true and accurate, however, no warranty as to accuracy is provided by the Developer. The Lot owner shall confirm all dimensions, elevations, and other information provided herein prior to use of this plan. This Lot Plan shall not be construed as a legal survey. The Developer and its employees, contractors, consultants and agents shall not be liable for any losses arising from use of this plan. E&OE.

10 May 2023

SL 39

SL 24

STRATA ACCESS ROUTE

SL 23

22.10

30.00

PROPERTY LINE

SL 22

BUILDING ENVELOPE

30.00

22.10

SL 21

SL 110

SL 20

(c)

SL 111

Lot Area: 662 m²

Building Envelope Area: 420 m²

Front Yard Setback: 2.0 m

Rear Yard Setback: 6.0 m

Interior Side Yard Setback: 1.5 m



KOOCANUSA VILLAGE

Strata Lot 22, Plan EPS9008 - Crystal Lake

This Lot Plan is provided for information purposes only. This Lot Plan has been prepared based on the most recent information available at the time and is believed to be true and accurate, however, no warranty as to accuracy is provided by the Developer. The Lot owner shall confirm all dimensions, elevations, and other information provided herein prior to use of this plan. This Lot Plan shall not be construed as a legal survey. The Developer and its employees, contractors, consultants and agents shall not be liable for any losses arising from use of this plan. E&OE.

10 May 2023



Lot Area: 662 m²
 Building Envelope Area: 420 m²
 Front Yard Setback: 2.0 m
 Rear Yard Setback: 6.0 m
 Interior Side Yard Setback: 1.5 m



Strata Lot 23, Plan EPS9008 - Crystal Lake

This Lot Plan is provided for information purposes only. This Lot Plan has been prepared based on the most recent information available at the time and is believed to be true and accurate, however, no warranty as to accuracy is provided by the Developer. The Lot owner shall confirm all dimensions, elevations, and other information provided herein prior to use of this plan. This Lot Plan shall not be construed as a legal survey. The Developer and its employees, contractors, consultants and agents shall not be liable for any losses arising from use of this plan. E&OE.

10 May 2023



Lot Area: 662 m²
 Building Envelope Area: 420 m²
 Front Yard Setback: 2.0 m
 Rear Yard Setback: 6.0 m
 Interior Side Yard Setback: 1.5 m



Strata Lot 24, Plan EPS9008 - Crystal Lake

This Lot Plan is provided for information purposes only. This Lot Plan has been prepared based on the most recent information available at the time and is believed to be true and accurate, however, no warranty as to accuracy is provided by the Developer. The Lot owner shall confirm all dimensions, elevations, and other information provided herein prior to use of this plan. This Lot Plan shall not be construed as a legal survey. The Developer and its employees, contractors, consultants and agents shall not be liable for any losses arising from use of this plan. E&OE.

10 May 2023



Lot Area: 662 m²
 Building Envelope Area: 420 m²
 Front Yard Setback: 2.0 m
 Rear Yard Setback: 6.0 m
 Interior Side Yard Setback: 1.5 m



Strata Lot 25, Plan EPS9008 - Crystal Lake

This Lot Plan is provided for information purposes only. This Lot Plan has been prepared based on the most recent information available at the time and is believed to be true and accurate, however, no warranty as to accuracy is provided by the Developer. The Lot owner shall confirm all dimensions, elevations, and other information provided herein prior to use of this plan. This Lot Plan shall not be construed as a legal survey. The Developer and its employees, contractors, consultants and agents shall not be liable for any losses arising from use of this plan. E&OE.

10 May 2023

SL 35

SL 28

STRATA ACCESS ROUTE

SL 27

22.10

30.00

PROPERTY LINE

SL 26

BUILDING ENVELOPE

30.00

22.10

SL 25

(c)

SL 24

SL 107

Lot Area: 662 m²

Building Envelope Area: 420 m²

Front Yard Setback: 2.0 m

Rear Yard Setback: 6.0 m

Interior Side Yard Setback: 1.5 m



Strata Lot 26, Plan EPS9008 - Crystal Lake

This Lot Plan is provided for information purposes only. This Lot Plan has been prepared based on the most recent information available at the time and is believed to be true and accurate, however, no warranty as to accuracy is provided by the Developer. The Lot owner shall confirm all dimensions, elevations, and other information provided herein prior to use of this plan. This Lot Plan shall not be construed as a legal survey. The Developer and its employees, contractors, consultants and agents shall not be liable for any losses arising from use of this plan. E&OE.



KOOCANUSA VILLAGE

10 May 2023



Lot Area: 662 m²
 Building Envelope Area: 420 m²
 Front Yard Setback: 2.0 m
 Rear Yard Setback: 6.0 m
 Interior Side Yard Setback: 1.5 m



Strata Lot 27, Plan EPS9008 - Crystal Lake

This Lot Plan is provided for information purposes only. This Lot Plan has been prepared based on the most recent information available at the time and is believed to be true and accurate, however, no warranty as to accuracy is provided by the Developer. The Lot owner shall confirm all dimensions, elevations, and other information provided herein prior to use of this plan. This Lot Plan shall not be construed as a legal survey. The Developer and its employees, contractors, consultants and agents shall not be liable for any losses arising from use of this plan. E&OE.

10 May 2023



Lot Area: 662 m²

Building Envelope Area: 420 m²

Front Yard Setback: 2.0 m

Rear Yard Setback: 6.0 m

Interior Side Yard Setback: 1.5 m



Strata Lot 28, Plan EPS9008 - Crystal Lake

This Lot Plan is provided for information purposes only. This Lot Plan has been prepared based on the most recent information available at the time and is believed to be true and accurate, however, no warranty as to accuracy is provided by the Developer. The Lot owner shall confirm all dimensions, elevations, and other information provided herein prior to use of this plan. This Lot Plan shall not be construed as a legal survey. The Developer and its employees, contractors, consultants and agents shall not be liable for any losses arising from use of this plan. E&OE.

10 May 2023



Lot Area: 662 m²
 Building Envelope Area: 420 m²
 Front Yard Setback: 2.0 m
 Rear Yard Setback: 6.0 m
 Interior Side Yard Setback: 1.5 m



Strata Lot 29, Plan EPS9008 - Crystal Lake

This Lot Plan is provided for information purposes only. This Lot Plan has been prepared based on the most recent information available at the time and is believed to be true and accurate, however, no warranty as to accuracy is provided by the Developer. The Lot owner shall confirm all dimensions, elevations, and other information provided herein prior to use of this plan. This Lot Plan shall not be construed as a legal survey. The Developer and its employees, contractors, consultants and agents shall not be liable for any losses arising from use of this plan. E&OE.



KOOCANUSA VILLAGE

10 May 2023



SL 31

STRATA ACCESS ROUTE

COMMON PROPERTY GREENSPACE

22.10

30.00

PROPERTY LINE

SL 30

BUILDING ENVELOPE

30.00

22.10

SL 29

SL 103

28

SL 104



Lot Area: 662 m²
 Building Envelope Area: 420 m²

Front Yard Setback: 2.0 m
 Rear Yard Setback: 6.0 m
 Interior Side Yard Setback: 1.5 m



KOOCANUSA VILLAGE

Strata Lot 30, Plan EPS9008 - Crystal Lake

This Lot Plan is provided for information purposes only. This Lot Plan has been prepared based on the most recent information available at the time and is believed to be true and accurate, however, no warranty as to accuracy is provided by the Developer. The Lot owner shall confirm all dimensions, elevations, and other information provided herein prior to use of this plan. This Lot Plan shall not be construed as a legal survey. The Developer and its employees, contractors, consultants and agents shall not be liable for any losses arising from use of this plan. E&OE.

10 May 2023



Lot Area: 704 m²
 Building Envelope Area: 455 m²

Front Yard Setback: 2.0 m
 Rear Yard Setback: 6.0 m
 Interior Side Yard Setback: 1.5 m



Strata Lot 31, Plan EPS9008 - Crystal Lake

This Lot Plan is provided for information purposes only. This Lot Plan has been prepared based on the most recent information available at the time and is believed to be true and accurate, however, no warranty as to accuracy is provided by the Developer. The Lot owner shall confirm all dimensions, elevations, and other information provided herein prior to use of this plan. This Lot Plan shall not be construed as a legal survey. The Developer and its employees, contractors, consultants and agents shall not be liable for any losses arising from use of this plan. E&OE.



KOOCANUSA VILLAGE

10 May 2023



Lot Area: 704 m²
 Building Envelope Area: 455 m²
 Front Yard Setback: 2.0 m
 Rear Yard Setback: 6.0 m
 Interior Side Yard Setback: 1.5 m



Strata Lot 32, Plan EPS9008 - Crystal Lake

This Lot Plan is provided for information purposes only. This Lot Plan has been prepared based on the most recent information available at the time and is believed to be true and accurate, however, no warranty as to accuracy is provided by the Developer. The Lot owner shall confirm all dimensions, elevations, and other information provided herein prior to use of this plan. This Lot Plan shall not be construed as a legal survey. The Developer and its employees, contractors, consultants and agents shall not be liable for any losses arising from use of this plan. E&OE.



KOOCANUSA VILLAGE

10 May 2023



Lot Area: 704 m²
 Building Envelope Area: 455 m²
 Front Yard Setback: 2.0 m
 Rear Yard Setback: 6.0 m
 Interior Side Yard Setback: 1.5 m



Strata Lot 33, Plan EPS9008 - Crystal Lake

This Lot Plan is provided for information purposes only. This Lot Plan has been prepared based on the most recent information available at the time and is believed to be true and accurate, however, no warranty as to accuracy is provided by the Developer. The Lot owner shall confirm all dimensions, elevations, and other information provided herein prior to use of this plan. This Lot Plan shall not be construed as a legal survey. The Developer and its employees, contractors, consultants and agents shall not be liable for any losses arising from use of this plan. E&OE.





Lot Area: 704 m²
 Building Envelope Area: 455 m²
 Front Yard Setback: 2.0 m
 Rear Yard Setback: 6.0 m
 Interior Side Yard Setback: 1.5 m



Strata Lot 34, Plan EPS9008 - Crystal Lake

This Lot Plan is provided for information purposes only. This Lot Plan has been prepared based on the most recent information available at the time and is believed to be true and accurate, however, no warranty as to accuracy is provided by the Developer. The Lot owner shall confirm all dimensions, elevations, and other information provided herein prior to use of this plan. This Lot Plan shall not be construed as a legal survey. The Developer and its employees, contractors, consultants and agents shall not be liable for any losses arising from use of this plan. E&OE.



KOOCANUSA VILLAGE

10 May 2023



Lot Area: 704 m²
 Building Envelope Area: 455 m²

Front Yard Setback: 2.0 m
 Rear Yard Setback: 6.0 m
 Interior Side Yard Setback: 1.5 m



Strata Lot 35, Plan EPS9008 - Crystal Lake

This Lot Plan is provided for information purposes only. This Lot Plan has been prepared based on the most recent information available at the time and is believed to be true and accurate, however, no warranty as to accuracy is provided by the Developer. The Lot owner shall confirm all dimensions, elevations, and other information provided herein prior to use of this plan. This Lot Plan shall not be construed as a legal survey. The Developer and its employees, contractors, consultants and agents shall not be liable for any losses arising from use of this plan. E&OE.

10 May 2023



Lot Area: 704 m²
 Building Envelope Area: 455 m²

Front Yard Setback: 2.0 m
 Rear Yard Setback: 6.0 m
 Interior Side Yard Setback: 1.5 m



Strata Lot 36, Plan EPS9008 - Crystal Lake

This Lot Plan is provided for information purposes only. This Lot Plan has been prepared based on the most recent information available at the time and is believed to be true and accurate, however, no warranty as to accuracy is provided by the Developer. The Lot owner shall confirm all dimensions, elevations, and other information provided herein prior to use of this plan. This Lot Plan shall not be construed as a legal survey. The Developer and its employees, contractors, consultants and agents shall not be liable for any losses arising from use of this plan. E&OE.



KOOCANUSA VILLAGE

10 May 2023



Lot Area: 704 m²

Building Envelope Area: 455 m²

Front Yard Setback: 2.0 m

Rear Yard Setback: 6.0 m

Interior Side Yard Setback: 1.5 m



Strata Lot 37, Plan EPS9008 - Crystal Lake

This Lot Plan is provided for information purposes only. This Lot Plan has been prepared based on the most recent information available at the time and is believed to be true and accurate, however, no warranty as to accuracy is provided by the Developer. The Lot owner shall confirm all dimensions, elevations, and other information provided herein prior to use of this plan. This Lot Plan shall not be construed as a legal survey. The Developer and its employees, contractors, consultants and agents shall not be liable for any losses arising from use of this plan. E&OE.

10 May 2023



Lot Area: 704 m²
 Building Envelope Area: 455 m²

Front Yard Setback: 2.0 m
 Rear Yard Setback: 6.0 m
 Interior Side Yard Setback: 1.5 m



Strata Lot 38, Plan EPS9008 - Crystal Lake

This Lot Plan is provided for information purposes only. This Lot Plan has been prepared based on the most recent information available at the time and is believed to be true and accurate, however, no warranty as to accuracy is provided by the Developer. The Lot owner shall confirm all dimensions, elevations, and other information provided herein prior to use of this plan. This Lot Plan shall not be construed as a legal survey. The Developer and its employees, contractors, consultants and agents shall not be liable for any losses arising from use of this plan. E&OE.



KOOCANUSA VILLAGE

10 May 2023



Lot Area: 704 m²
 Building Envelope Area: 455 m²
 Front Yard Setback: 2.0 m
 Rear Yard Setback: 6.0 m
 Interior Side Yard Setback: 1.5 m



Strata Lot 39, Plan EPS9008 - Crystal Lake

This Lot Plan is provided for information purposes only. This Lot Plan has been prepared based on the most recent information available at the time and is believed to be true and accurate, however, no warranty as to accuracy is provided by the Developer. The Lot owner shall confirm all dimensions, elevations, and other information provided herein prior to use of this plan. This Lot Plan shall not be construed as a legal survey. The Developer and its employees, contractors, consultants and agents shall not be liable for any losses arising from use of this plan. E&OE.



KOOCANUSA VILLAGE

10 May 2023



Lot Area: 704 m²
 Building Envelope Area: 455 m²

Front Yard Setback: 2.0 m
 Rear Yard Setback: 6.0 m
 Interior Side Yard Setback: 1.5 m



Strata Lot 40, Plan EPS9008 - Crystal Lake

This Lot Plan is provided for information purposes only. This Lot Plan has been prepared based on the most recent information available at the time and is believed to be true and accurate, however, no warranty as to accuracy is provided by the Developer. The Lot owner shall confirm all dimensions, elevations, and other information provided herein prior to use of this plan. This Lot Plan shall not be construed as a legal survey. The Developer and its employees, contractors, consultants and agents shall not be liable for any losses arising from use of this plan. E&OE.



KOOCANUSA VILLAGE

10 May 2023



Lot Area: 802 m²
 Building Envelope Area: 439 m²

Front Yard Setback: 2.0 m
 Rear Yard Setback: 6.0 m
 Interior Side Yard Setback: 1.5 m
 Exterior Side Yard Setback: 4.5 m



Strata Lot 41, Plan EPS9008 - Crystal Lake

This Lot Plan is provided for information purposes only. This Lot Plan has been prepared based on the most recent information available at the time and is believed to be true and accurate, however, no warranty as to accuracy is provided by the Developer. The Lot owner shall confirm all dimensions, elevations, and other information provided herein prior to use of this plan. This Lot Plan shall not be construed as a legal survey. The Developer and its employees, contractors, consultants and agents shall not be liable for any losses arising from use of this plan. E&OE.



KOOCANUSA VILLAGE

10 May 2023